

# Instructions for **JetCal**

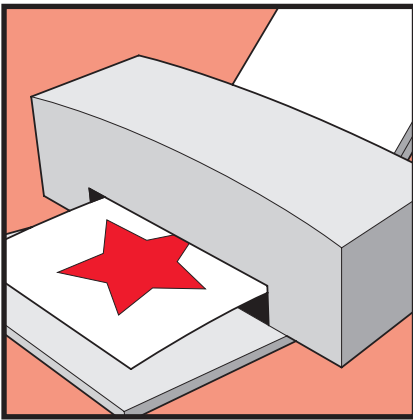

**1.** On the normal print setting, print the design on the white side of the paper using an inkjet printer. Allow print to dry for 1 hour.

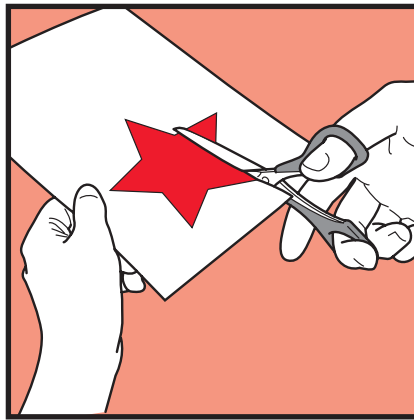

**2.** Cut around the edge of the design.

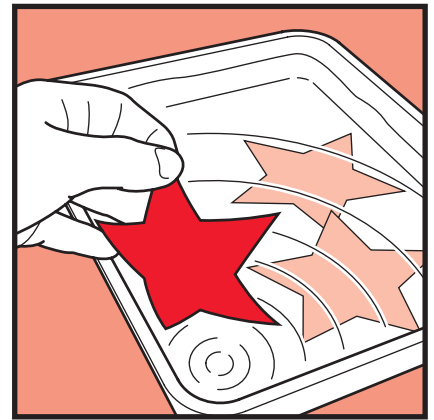

**3.** Soak in a suitably sized container of tap water for 1 minute. Remove from water.

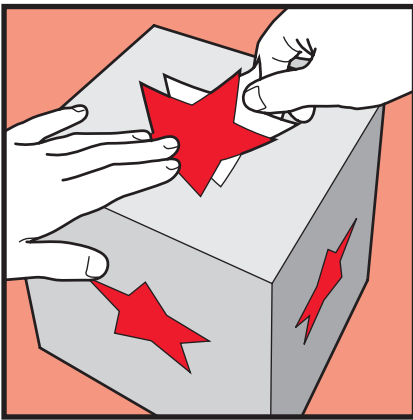

**4.** Slide design from backing paper onto chosen surface. Please note that unprinted areas will appear white.

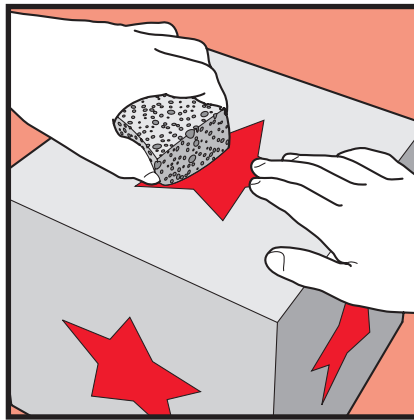

**5.** Gently wipe over surface with a wet sponge.

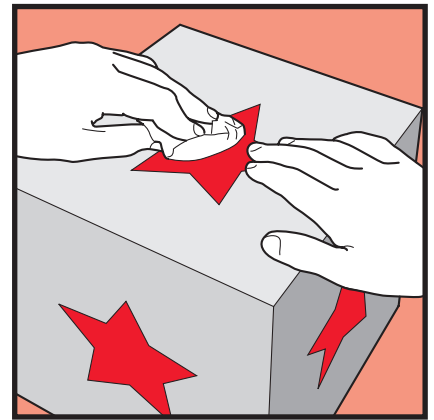

**6.** Remove remaining water from surface with a clean tissue. Allow the decal to dry for 1 hour.

#### IMPORTANT NOTICE

The Decal Paper Store cannot accept liability, direct or indirect, for the misuse of this product. Users should follow the instructions provided and must satisfy themselves as to the suitability of the product for the printing method and application used. All warranties, statutory and implied, as to the fitness for purpose of the product are expressly excluded. The liability of The Decal Paper Store is governed by the Terms and Conditions of Sale (available on the [www.thedecalpaperstore.com](http://www.thedecalpaperstore.com) website), which take precedence over this Notice in the event of any conflict.

**E mail: [questions@thedecalpaperstore.com](mailto:questions@thedecalpaperstore.com)**  
**Web: [www.thedecalpaperstore.com](http://www.thedecalpaperstore.com)**